

Job Name/Location:

Tag #:

Date:

For:	File	Resubmit
	Approval	Other_____

PO No.:

Architect: _____ GC: _____

Engr: _____ Mech: _____

Rep: _____

(Company)

(Project Manager)

LMVN240HV
Multi F 2-Way Vertical/Horizontal Air Handling Unit
24,000 Btu/h



Performance:

Nominal Cooling Capacity (Btu/h)	24,000
Nominal Heating Capacity (Btu/h)	27,000

Cooling Nominal Test Conditions:

Indoor: 80°F DB / 67°F WB
Outdoor: 95°F DB / 75°F WB

Heating Nominal Test Conditions:

Indoor: 70°F DB / 60°F WB
Outdoor: 47°F DB / 43°F WB

Electrical:

Power Supply (V/Hz/Ø)	208-230/60/1
Rated Amps (A)	0.59

Piping:

Installed Liquid Pipe (in., O.D.)	ø1/4
Installed Vapor Pipe (in., O.D.)	ø1/2
Liquid Connection (in., O.D.)	ø1/4
Vapor Connection (in., O.D.)	ø1/2
Drain (in., O.D. / I.D.)	3/4 FPT
Temperature Sensor	Thermistor

Standard Features:

- Access Panel for Field Supplied Air Filter (16 x 20 x 1 inch)

Controls Features:

- ESP Control
- Hot Start
- Auto Restart
- Child Lock
- Inverter (Variable Speed Fan)
- Group Control
- Sleep Mode
- Timer On / Off
- Controller Sold Separately

Optional Accessories:

- Simple Remote Controller - PREMTC00U
- MultiSITE™ CRC1 Controller - PREMTBVC0
- MultiSITE™ CRC1+ Controller - PREMTBVC1
- Premium Remote Controller - PREMTA000
- Wireless Handheld Remote Controller - PQWRHQ0FDB²
- AC Smart 5 - PACS5A000
- ACP 5 - PACP5A000
- LonWorks Gateway - PLNWKB100
- AC Smart IV BACnet - PBACNA000
- ACP IV BACnet Gateway - PQNFB17C2
- Dry Contact (1 contact, 24 VAC external power) - PDRYCB100
- Dry Contact for Third Party Thermostat - PDRYCB300
- Dry Contact for (2 setpoints) - PDRYCB400
- Remote Temperature Button Sensor - ZRTBS01
- 5 kW Electric Heater - ANEH053B1
- 10 kW Electric Heater - ANEH103B2

Entering Mixed Air:

Cooling (°F DB)	57 ~ 77
Heating (°F WB)	59 ~ 81

Unit Data:

Refrigerant Type	R410A
Refrigerant Control	EEV
Sound Pressure (H/M/L) dB(A) ³	43 / 42 / 41
Net Weight (lbs.)	117
Shipping Weight (lbs.)	130

Fan:

Type	Sirocco
Quantity	1
Motor/Drive	Brushless Digitally Controlled/Direct
Air Flow H/M/L (CFM)	710 / 640 / 480
External Static Pressure ^{4,5} (in wg)	0.5
Minimum External Static Pressure ⁶	0.1
Maximum External Static Pressure ⁶	1.0

Notes:

1. Acceptable operating voltage: 187V-253V.
2. Requires an LG wired thermostat.
3. Sound Pressure levels are tested in an anechoic chamber under ISO Standard 3745.
4. Adjust fan speed to correct for static pressure increases when using field-supplied air filter.
5. At factory fan speed setting.
6. Air flow rate (CFM) at high speed.
7. See Engineering Manual for sensible and latent capacities.
8. All communication / connection (power) cable from the outdoor unit to the indoor unit is field supplied and must be a minimum of four-conductor, 18 AWG, stranded, shielded or unshielded (if shielded, it must be grounded to the chassis of the outdoor unit only), and must comply with applicable local and national codes.
9. Power wiring cable size must comply with the applicable local and national code.
10. The indoor unit comes with a dry helium charge.
11. Corresponding refrigerant piping length is in accordance with standard length of each outdoor unit and the level difference is 0 ft. All capacities are net with a combination ratio between 95 - 105%.
12. Must follow installation instructions in the applicable LG installation manual.
13. Controller not included.



Job Name/Location: _____

LMVN240HV
 Multi F 2-Way Vertical/Horizontal Air Handling Unit
 24,000 Btu/h



Tag No.: _____

Date: _____

PO No.: _____

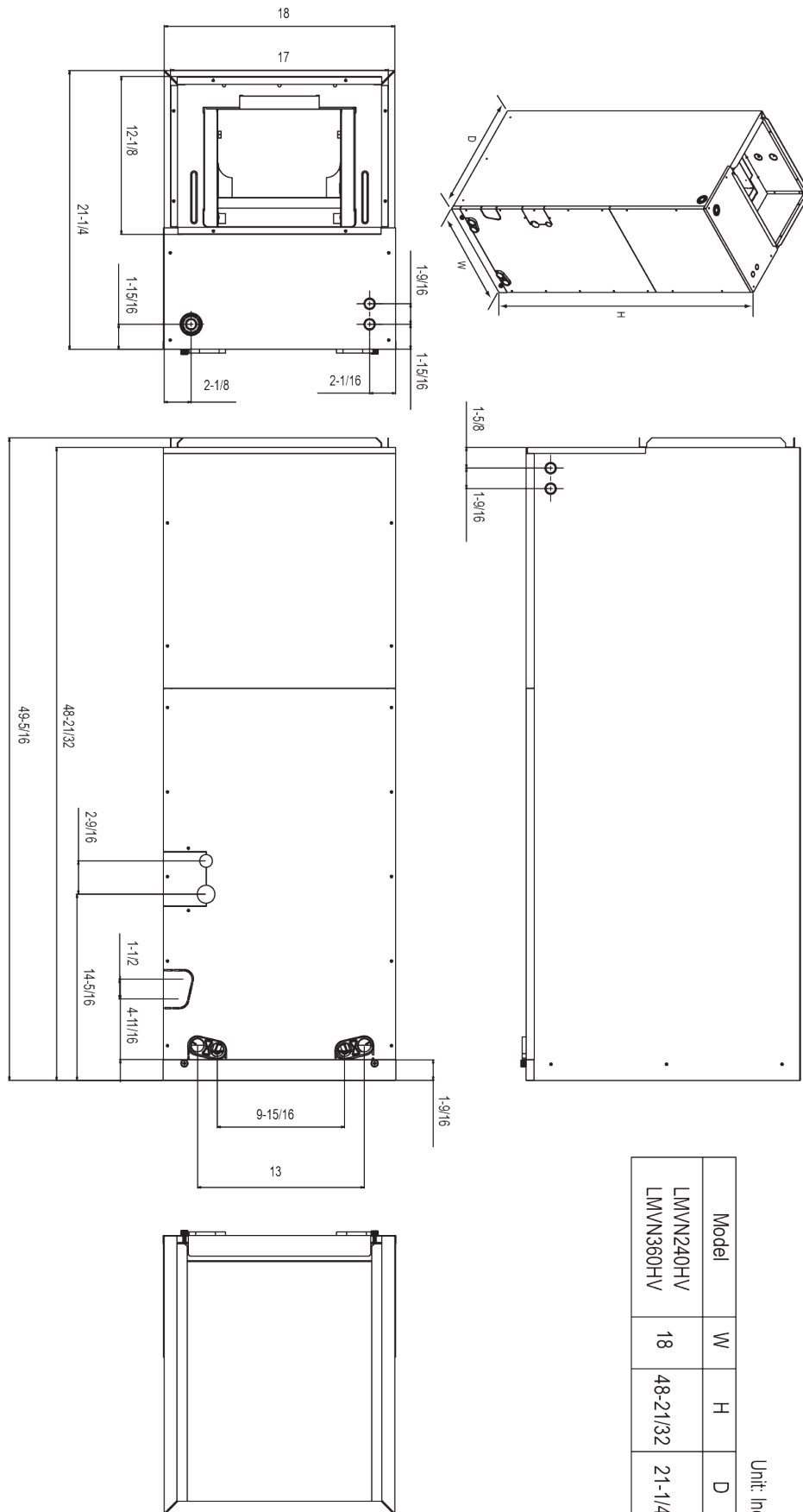

Model	W	H	D
LMVN240HV	18	48-21/32	21-1/4
LMVN360HV			

Unit: Inch